

User Manual

VANQUISH
R-TOUCH



The latest versions of manual, drivers and applications are available on www.pentagram.eu

2007-06-04

NOTE! Any information and technical data are subject to change without prior notification and/or indication in this manual.

Copyright © 2007 PENTAGRAM

All rights reserved; copying and reproduction is strictly forbidden.

INDEX

INTRODUCTION.....	5
SYSTEM REQUIREMENTS.....	5
BOX CONTENTS.....	5
BEFORE USE.....	6
SAFETY PRECAUTIONS.....	6
BATTERY CHARGING.....	7
TF CARD READER.....	7
USAGE.....	8
PLAYER'S APPEARANCE.....	8
BUTTONS.....	9
TURNING PLAYER ON.....	10
BUTTONS LOCK.....	10
NAVIGATION.....	11
MAIN MENU.....	11
MUSIC MENU.....	12
VIDEO MENU.....	13
RADIO MENU.....	14
PHOTO MENU.....	15
TEXT MENU.....	15
RECORD MENU.....	16
EXPLORER MENU.....	17
GAME MENU.....	17
SETTINGS MENU.....	18
CONNECTING TO COMPUTER.....	20
VIDEO FILES CONVERSION.....	20
FIRMWARE UPGRADE.....	21
TROUBLESHOOTING.....	22
SPECIFICATION.....	23



Introduction

Thank you for purchasing PENTAGRAM Vanquish R Touch. This player is a new type of portable digital multimedia player, it perfectly combines digital audio & video playing (MP3, WMA, WMV, ASF, WAV and AVI), recording, FM tuner, photo/eBook browsing, game and portable TF (TransFlash a.k.a. MicroSD) memory card reader.

System Requirements

- IBM PC, notebook or Mac with available USB port;
- Operating system: Windows 98 / 98SE / Me / 2000 / XP, MacOS 10 or newer, Linux 2.4.2 or newer.

Box Contents

- PENTAGRAM Vanquish R Touch (P 5112)
- Earphones
- USB cable
- CD with drivers and applications
- User Manual
- Neck strap
- Power adapter
- Carrying pouch

Before use

Safety precautions

- Don't use too much strength when using Touch buttons, you can damage touch panel;
- Please avoid placing player directly in the sunshine or dusty, humid place or place with extremely low or high temperatures (i.e. car with closed windows in summer);
- Please avoid dropping or impact upon player;
- Don't let liquid or objects into player;
- Don't use chemicals, such as gasoline or other diluents, upon player's surface;
- Clean player only with soft cloth;
- Before cleaning, disconnect player from computer or other power source;
- When start using the unit, please fully charge and discharge the battery for about 2 - 3 times to ensure maximum battery life and power capacity;
- Please do not disassemble any part of the unit, any unauthorized disassembling will cause termination of PENTAGRAM official warranty;
- Please don't use wet hand to plug/unplug or contact player for preventing shock or damage;
- Please don't unplug player while data is transferring with the computer, otherwise the data may be lost;
- Please don't judder, otherwise player may be damaged;
- Files or data stored in player cannot completely avoid being destroyed or lost due to improper use or other reasons. Please backup files and data when necessary;

Battery charging

When start using the unit, please fully charge and discharge the battery for about 2 - 3 times to ensure maximum battery life and power capacity.

In top right corner of LCD display (in most modes) battery charge indicator is visible. If indicator is green – battery is fully charged, if it's red– battery is almost discharged and must be charged as soon as possible. During charging indicator changes its color.

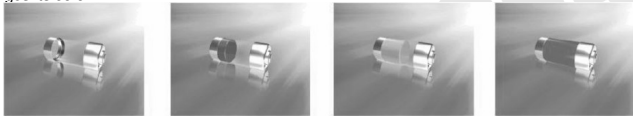

To charge battery:

- connect player to computer's USB port;
- connect player to power outlet via attached power adapter;
- connect player to car lighter socket via car USB charger (not included).

TF card reader

If the memory of the Player cannot satisfy your demand, you can use a TF memory card to extend memory. It is recommended to turn player off before inserting or removing card.

When memory card is properly inserted and contains files supported by player, these files can be accessed in appropriate mode of player.

Usage

Player's appearance

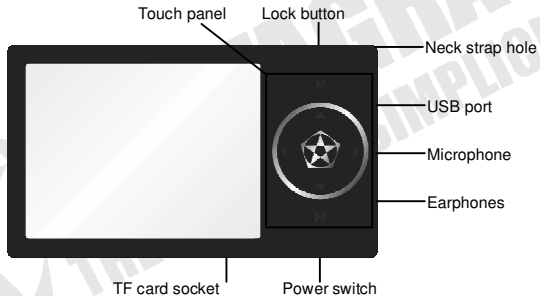

Buttons

Player's Touch Panel is sensitive and it's not recommended to use too much pressure when using it. Slight touch is enough for player to register button press. Familiarization with Touch Panel and required pressure is easy. All buttons have main function available all time and functions that depend on selected mode.

General

Power switch – power on/off player

Lock button – hold for 4s – turn on/off player

Lock button and **▶ ||** – hold both for 2s – enable/disable button lock – when player is in lock mode padlock icon appears near battery indicator.

M – hold for 3s – return to main menu.

Main Menu:

◀ and **▶** – select main menu option.

M – confirm selection.

Submenu / file list

▲ and **▼** – select submenu/list option.

M – confirm selection.

◀ – return to previous menu / parent folder.

Lock button – on file list – delete selected file.

Turning player on

To turn on player, you must move power switch to On position (closer to display) and then hold for 4 seconds lock button.

To turn off player either hold for 4 seconds lock button or move power switch to Off position (closer to connectors).

Buttons lock

To lock player's buttons press and hold simultaneously for 2 seconds lock button and ▶ || button. When player is in lock mode padlock icon appears near battery indicator. To lock player's buttons press and hold simultaneously for 2 seconds lock button and ▶ || button.



PENTAGRAM
THE PERFECT SIMPLICITY

Navigation

Main Menu

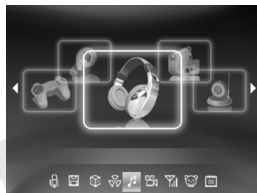

Use ◀ and ▶ buttons to navigate through the main menu and press **M** to confirm selection. You can return to Main menu anytime by holding **M** button for 2-3 seconds.

Music Menu



In this mode you can listen to music in MP3, WMA and WAV formats. Buttons functions in this mode are:

M – audio file list.

◀ / ▶ – previous / next audio file.

▲ / ▼ – volume up / down.

▶ || – pause / unpaue.

Lock button – A-B repeat:

- press lock button, to select start point (A),
- press lock button, to select end point (B).

Player will repeat continuously selected fragment. To disable A-B repeat press lock button.

Video Menu



This mode is used for playing video files. Supported files are in AVI format (320x240) compressed with XVID codec. If video file is not compatible with player, you can use AviConverter application to convert it to supported format. Buttons functions in this mode are:

M – video file list.

◀ / ▶ – previous / next video file.

▲ / ▼ – volume up / down.

▶ || – pause / unpause.

Radio Menu



This mode is FM tuner. In this mode connected earphones are used as antenna and should be connected before station tuning. Buttons functions in this mode are:

M – Radio mode submenu:

- **Manual** – manual scanning.
- **Preset** – disable scanning.
- **Save** – save current station on selected position.
- **Del** – delete station from selected position
- **Auto** – automatic scanning and saving.

◀ / ▶ (Manual) – change frequency by 0,1MHz, hold to scan for nearest station.

◀ / ▶ (Preset) – previous / next saved station.

▲ / ▼ – Volume up / down.

Lock button – FM recording, see **Record** for details.

Photo Menu

This mode is photo (JPG format) browser. Buttons functions in this mode are:

M – graphic file list.

◀ / ▶ – previous / next file.

▶ || – enable / disable slideshow.

Text Menu

This menu is EBook (Text file) browser. Buttons functions in this mode are:

M – text file list.

▲ / ▼ – scroll up / down – one line.

◀ / ▶ – scroll up / down – page.

▶ || (press) – save bookmark menu.

▶ || (hold) – auto-scroll.

Lock button – load bookmark menu.

PENTAGRAM
THE PERFECT SIMPLICITY

Record Menu



This mode can be used to record voice from built-in microphone (select Record from main menu) or from FM (press lock button in **Radio** mode). Buttons functions in this mode are:

M – save recording and return to main menu / **Radio** mode.

Lock button – start / pause recording.

Explorer Menu

This mode is file browser. Select file to play it in appropriate mode (i.e. MP3 file in **Music** mode). Buttons functions in this mode are:

▲ and ▼ – file / folder selection.

M – confirm selection.

◀ – level up.

Lock button – delete file.

Game Menu

This mode is tetris-type game. Buttons functions in this mode are:

◀ / ▶ – move brick left / right.

▲ – brick rotation (clockwise).

▼ – drop brick.

▶ || – game pause / resume.

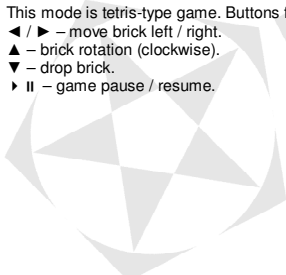

PENTAGRAM
THE PERFECT SIMPLICITY

Settings Menu

Settings Menu is used to configure various player functions.

Music – settings for **Music** mode:

- **Repeat mode** – select repeat mode:
 - Once – plays once selected file.
 - Repeat One – repeats continuously selected file.
 - Folder Once – plays once files in current folder.
 - Folder Repeat – repeats continuously files in current folder.
 - All Once – plays once all files.
 - All Repeat – repeats continuously all files.
 - Intro – plays first 10 seconds of each file.
- **Play Mode** – select play mode:
 - Order – normal order.
 - Shuffle – random order.
- **EQ Select (EQ)** select EQ:
 - Normal, 3D, Rock, Pop, Classic, Bass, Jazz, User EQ.
- **User EQ Set** – change parameters of **User EQ**. Use ◀ and ▶ buttons to select frequency and modify it using ▲ and ▼ buttons. Select Yes and press **M**, to save settings or **No**, to return to previous settings.

Radio – settings for **Radio** mode:

- **Stereo Switch** – select **Yes**, to enable stereo or **No**, to disable.
- **FM Region** – select FM region for FM tuner.

Record – settings for **Record** mode:

- **REC Quality** – select quality of recorded content: **High Quality** or **General Quality**.
- **REC Volume** – change volume of recorded content.

Display – display settings:

- **BLight Time** – change idle time, after which backlight or display will be turned off.
- **Lum** – select display brightness.
- **Blight Mode** – select whether backlight or whole display will be turned off after idle time

Auto Play Set – settings for slideshow / auto scroll in **Text** and **Photo** modes:

- **Text** – time interval for auto scroll in **Text** mode.
- **Jpeg** – time interval for slideshow in **Photo** mode.

System – system settings:

- **Languages** – language selection. Available languages are: English, Spanish, French, German, Italian, Portuguese, Russian, Dutch and Polish.
- **About** – information regarding player – firmware version (**Ver**) and date (**Date**) and used / all memory of player (**FlashMem**) and inserted memory card (**CardMem**).

Upgrade – firmware upgrade. See **Firmware upgrade** chapter for more details.

PowerOff Time – select idle time, after which player will be turned off.

Default Set – select to restore all settings to default values.

Connecting to computer

The player has a high-speed USB2.0 port with the transmission speed of 5M/S, and is a standard USB disk, supports the systems including Windows98 (it needs to install the driver), over Windows2K (it's unnecessary to install the driver), Mac OS 10.3 and over, Linux Redhat 8.0 and over. It supports USB power supply and can be played without battery. After connecting to the PC (several seconds later), the player will display the On-line mode shown



Video files conversion

This player can convert the avi, rm, rmvb, mpg, mpeg, mp4, asf, wmv, mkv, dat or vob into avi video format via the attached video convert software.

1. Click and run the program of AVIConverter.exe;
2. Click **Add**, to open **Conversion Setting** dialog;
3. Select and set your desired parameters, select your desired video/audio file and AVI video file routine to be generated, click **Start to Convert** button, then begin to convert to AVI file.

Firmware Upgrade

NOTE:

Firmware upgrade is to improve and optimize the performance of the player. The normal work of the player would not be affected even if the firmware isn't upgraded. The wrong operation of upgrading firmware would cause the device not to work normally! The firmware upgrade software of this player does not apply to other series of players.

The player can upgrade or resume the damaged player driver via the tool software in the attached disk.

1. For the first upgrading of computer, insert the drive disk into the CD-ROM of computer, then connect the MP4 player with computer (it requires you to press and hold the **M** key), till it appears the program Installation Interface.
2. Implement the next step according to the Dialog box prompt, and select the "Upgrading Tool" folder in the attached disk in the "Browse" option of the fourth Dialog box, then click Confirm.
3. Operate as per the prompt in dialog box till the accomplishment
4. When the installation of programs required by computer is OK, you can begin the upgrading; select and run the firmware upgrading tool Consumer.exe (can be found in attached disk), then open the option and select *.rhw file.
5. Connect the player to PC via USB cable (press and hold the **M** key before the On-line operation), then click [Burnt Firmware] till the Auto Upgrading is achieved.

Troubleshooting

If you experience any of the following difficulties in using player, use the following guide for help. Should any problem persist, please visit www.pentagram.eu site and eventually contact PENTAGRAM Customer Service.

Symptoms	Possible cause	Remedy
Fail to power on	Low battery	Charge battery
Power off shortly after power on		
No sound output	The volume is 0	Turn up the volume
	Earphone doesn't connected well	Connect earphone correctly
Buttons doesn't work	Player hanged	Use Power switch to turn of and turn on player
	Button lock enabled	Disable button lock
Fail to connect with the computer	USB Cable doesn't connected correctly	Connect USB Cable correctly
	Driver hasn't been installed on Windows 98/98SE	Install the driver
Fail to copy files		Check the system settings whether be accordance with requirements
		Format player's memory and try again
Can't recording	Low battery	Charge battery
	Space insufficient	Delete some files
Can't play video	Format error	Convert video file

Specification

Function	Description	
Dimensions	80x47x9.8mm (W x H x D)	
Weight	~ 53g	
Display	LCD 2,4" 320x200 – 260k colors	
Memory capacity	1GB ~ 4GB	
Power supply	built-in Li-Ion 3,7V, charged via USB port or power adapter	
Working time	Music (power saving)	~9h
	Video	~4h
Radio FM	Frequency: China, Europe, U.S.A	87MHz – 108MHz
	Japan	76MHz – 90MHz
	station memory	30
Supported files	Music	MP3, WMA, WMV, ASF, WAV
	Video	AVI (XVid 320x200)
	Text	TXT
	Photo	JPG
Max. output power	10mW in left and right	
SNR	85dB	
Working temperature	5°C~40°C	
Supported languages	English, Spanish, French, German, Italian, Portuguese, Russian, Dutch, Polish	
Data transfer	PC computer, notebook or Mac with USB port	
Operating system	Windows 98/98SE/Me/2000/XP/Server2003, MacOS 10 or newer, Linux 2.4.2 or newer.	

* specification are subject to change without prior notice

NOTES

